

Lasetnet FO Connector 6.19 New Features (part VII)

2023-10-17 - Alice Petruzzella - Comments (0) - Lasetnet FO Connector New Features

Lasetnet for Dynamics 365

Release version: 6.19

Release date: 17th October 2023

Introduction

This page describes the enhancements in [Lasetnet FO Connector 6.19](#).

Click to view the [Release Notes](#) page.

Click to view the [Lasetnet FO Connector 6.19 New Features \(part I\)](#) page.

Click to view the [Lasetnet FO Connector 6.19 New Features \(part II\)](#) page.

Click to view the [Lasetnet FO Connector 6.19 New Features \(part III\)](#) page.

Click to view the [Lasetnet FO Connector 6.19 New Features \(part IV\)](#) page.

Click to view the [Lasetnet FO Connector 6.19 New Features \(part V\)](#) page.

Click to view the [Lasetnet FO Connector 6.19 New Features \(part VI\)](#) page.

Test & Performance Suite

Some extremely useful features have been added to the Test & Performance Suite (T&P).

Task recorder

- Ignore usage data (task recorder)
- New layout for printer dialog - "Tabbed form" (table of contents)
- Support for XPath validation (XML file)
- Ignore/reset personalization of Form(s)
- Support for Filter in report overview and within structure/elements
- Option to re-record from the UX Test

- Filter when exporting and importing reports (to support playback)

Check points

- Automatically compare PDF files
- Option to ignore Jobinfos when comparing XML files

Task recorder

The following two new parameters have been introduced for the UX (User Experience) testing in Test & performance suite (T&P).

Lasernet > Test and performance suite > Parameters > General

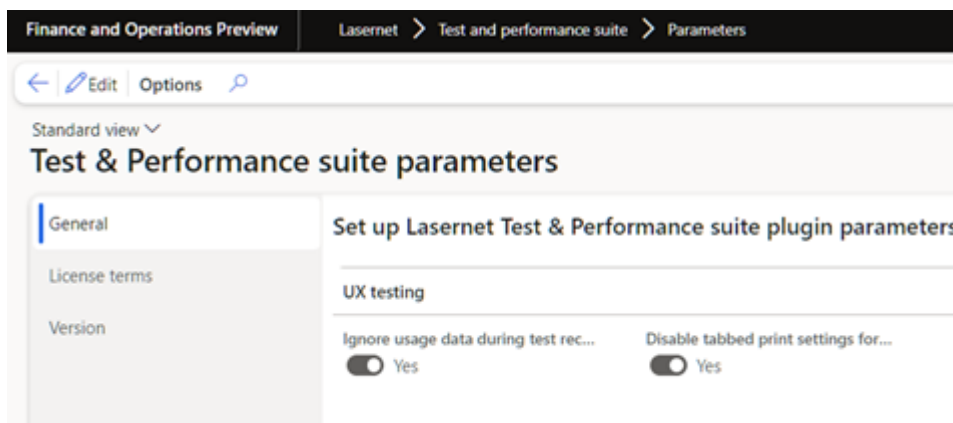

Ignore usage data during test recording and playback Will ignore the usage data when creating the recording(s) through the task-recorder.

Disable tabbed print settings form design The tabbed print settings are disabled within the printer dialog.

Ignore usage data during test recording and playback

Lasernet FO Connector saves much information as usage data (last values).

This could cause issue(s) in the playback of a recording and, therefore, issue(s) if the recordings are used for testing/automatic testing.

Example:

Print confirmation shown in the following image is saved within the usage data (last values) and could cause an issue if the recording does not contain the step for setting **Print confirmation**.

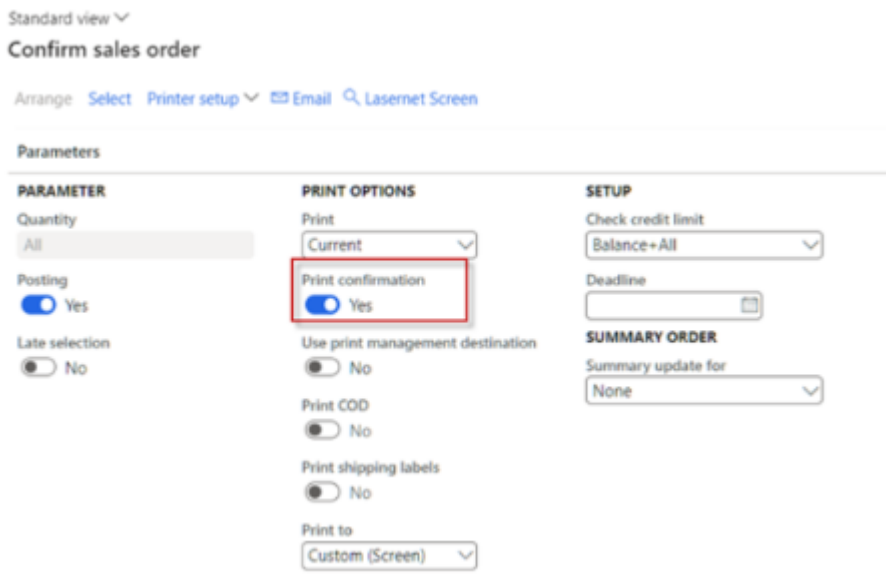

Playback of a recording for which the **Print confirmation** is not enabled, or for which the user running the playback does not have the **Print confirmation** enabled could get a block/stop in the recording.

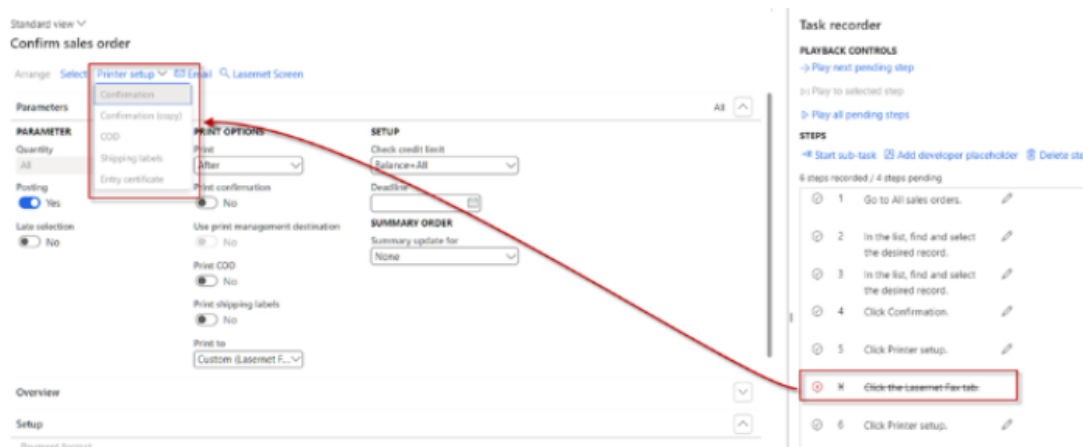

Test & Performance Suite 6.19 contains the option **Ignore usage data during test recording and playback**.

Location: **Lasetnet > Test and performance suite > Parameters > General > UX Testing**.

Enabling **Ignore usage data during test recording and playback** results in ignoring the usage data and, therefore, requires **Print confirmation** to be enabled as part of the recording. Otherwise, it is not possible to configure the destination.

Print confirmation gets disabled when preparing the recording even if it was previously enabled, as the usage data (last values) are ignored under the recording.

This ensures the recording is prepared from scratch (comparable to having no usage data (last values)).

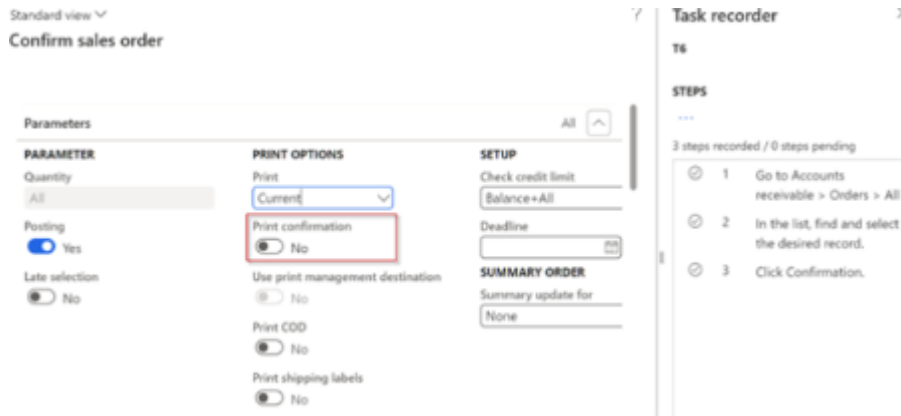

Disable tabbed print settings form design

Enabling the option **Disable tabbed print settings form design** ensures the possibility to playback a recording containing a setting for the destination/printer dialog.

In Lasernet FO Connector, playing back a recording containing a setting for the fax, such as the one shown in the following image, can end up setting the wrong destination, causing to either stop the playback or throw an error.

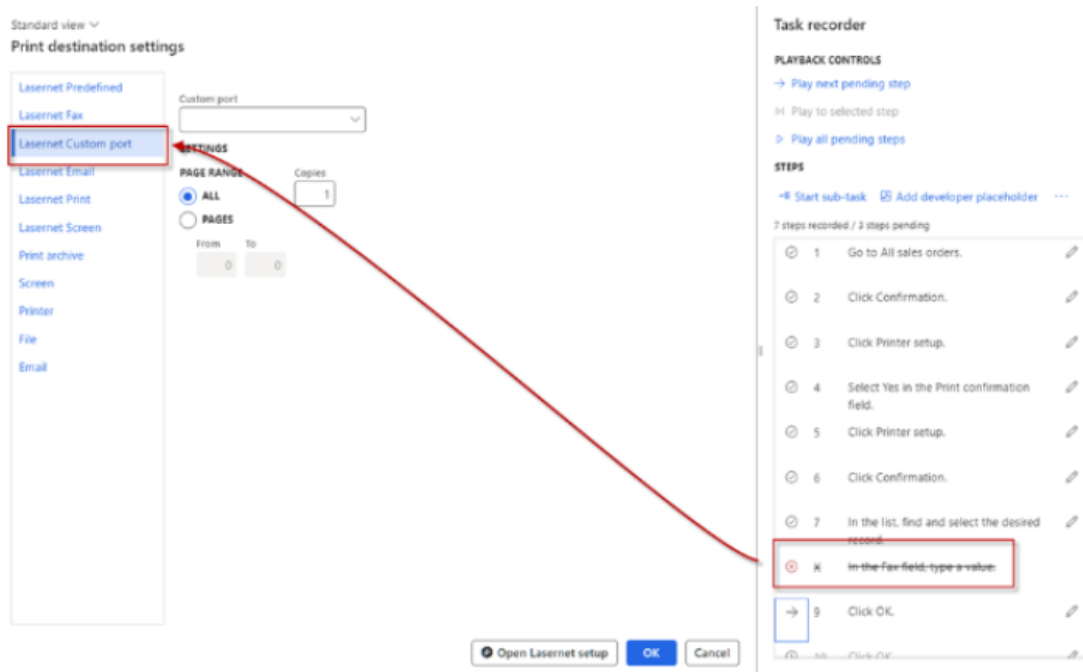

Lasernet FO Connector 6.19 uses “tabbed form” (table of contents) by default for the settings of the destination/printer settings.

This is to ensure the playback of a recording in case it contains a setting for the destination/printer settings.

Having the **Disable tabbed print settings form design** disabled shows the setting for the destination/printer settings as follows, and ensures the right selection if the recording is used for playback/test:

Standard view ▾

Print destination settings

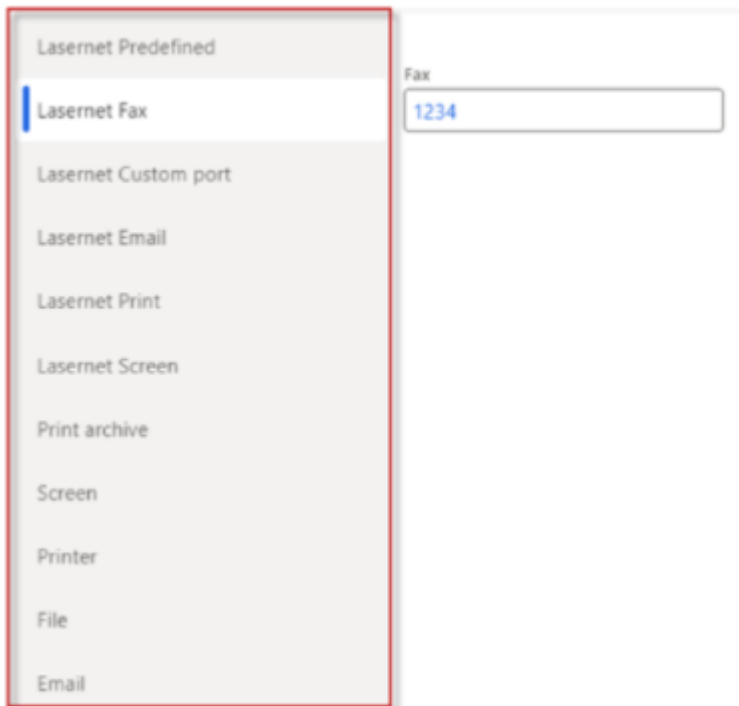

The screenshot shows a 'Print destination settings' window. On the left, there is a list of print destinations: 'Lasernet Predefined', 'Lasernet Fax', 'Lasernet Custom port', 'Lasernet Email', 'Lasernet Print', 'Lasernet Screen', 'Print archive', 'Screen', 'Printer', 'File', and 'Email'. 'Lasernet Fax' is selected, indicated by a blue vertical bar. To the right of the list, there is a 'Fax' label and a text input field containing the number '1234'.

Filter

The use of a filter in either the report list or within the structure/elements in Lasernet FO Connector was not properly recorded in previous versions of Lasernet FO Connector.

Being unable to have recordings that included the use of a filter could cause the playback of the recordings to stop.

This latest version ensures a complete recording, including the filter, is carried out, both in the report list and within the structure/elements. This recording can, therefore, be used for playback/test.

Validation of XPath

Another useful feature added as part of T&P is the option to validate a value within an XPath.

The option **Set task recorder validation path** appears when making a recording and when right-clicking the required XPath within the XML file.

```

<CompanyInfo>
  <LACQueryRecord_DONOT_CHANGE_CompanyInfo>1</LACQueryRecord_DONOT_CHANGE_CompanyInfo>
  <FIELD_CompanyInfo_RecId>22565422580</FIELD_CompanyInfo_RecId>
  <FIELD_CompanyInfo_Bank>USMF OPER</FIELD_CompanyInfo_Bank>
  <FIELD_CompanyInfo_CoRegNum>1234123400</FIELD_CompanyInfo_CoRegNum>
  <FIELD_CompanyInfo_email/>
  <FIELD_CompanyInfo_phone/>
  <FIELD_CompanyInfo_postalAddress_Address>123 Coffee Street Suite 300 Redmond, WA 98052 United States</
    FIELD_CompanyInfo_postalAddress_Address>
  <FIELD_CompanyInfo_RegNum/>
  <FIELD_CompanyInfo_url/>
  <FIELD_CompanyInfo_VATNum/>
  <FIELD_CompanyInfo_Name>Contoso Entertainment</FIELD_CompanyInfo_Name>
</CompanyInfo>
<BankAccountTable>
  <LACQueryRecord_DONOT_CHANGE_BankAccountTable>1</LACQueryRecord_DONOT_CHANGE_BankAccountTable>
  <FIELD_BankAccountTable_RecId>22565421180</FIELD_BankAccountTable_RecId>
  <FIELD_BankAccountTable_AccountNum>34567453</FIELD_BankAccountTable_AccountNum>
  <FIELD_BankAccountTable_IBAN/>

```

Skip Validation of JobInfos

A new option to skip the validation of the information in the JobInfos section within the XML file has been introduced.

This is useful when data has been restored from PROD and information like connection is not the same. The following example illustrates how to avoid different destinations to cause failure:

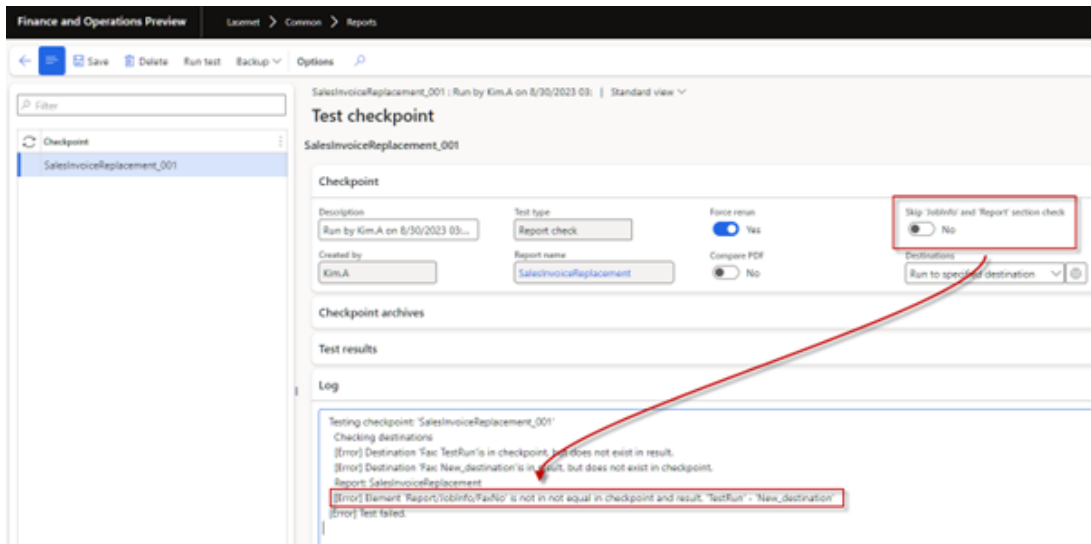

Re-recording

A new option for re-recording has been introduced.

Re-recording existing task recordings simplifies the process of adjusting an existing recording.

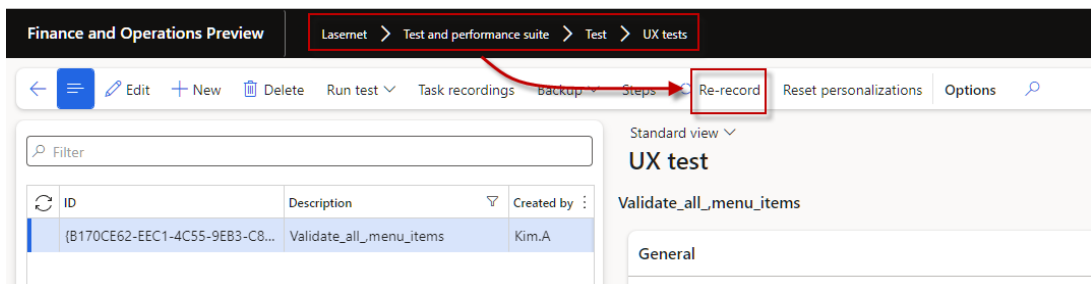

Reset personalizations

Resets embedded form personalizations for the forms used in the recording

Filter for Copy, Export and Import configuration

A filter is introduced when **Copying, Exporting** or **Importing** reports.

This is added to assist the playback of a recording as wrong reports could get selected.

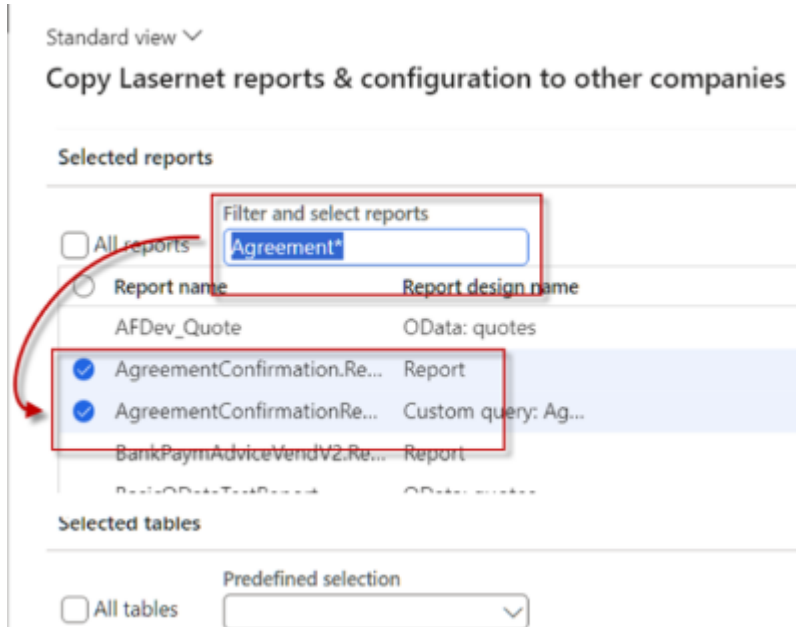

PDF comparison

It is possible to compare PDF files from the checkpoint in the Archive with the newly created PDF file.

This can be used as part of an upgrade in which checkpoints have been created prior to the upgrade and the PDF comparison is used to validate the documents (PDF files) before the upgrade with the documents after the upgrade.

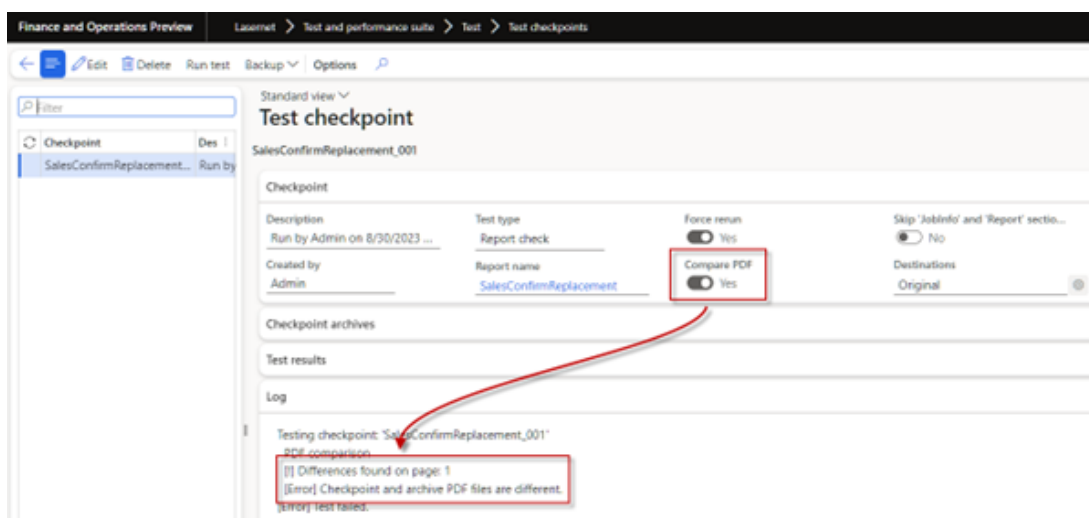

There is a limitation when using checkpoints with some reports and Force re-run in Lasetnet FO Connector.

Reports such as **Sales invoices**, **Sales confirmations**, **Purchase orders** have a journal/journal line, which ensures the possibility to use Force rerun when resending a document.

A report such as **Cust account statement** does not have any location besides the usage data (last values) and the report. Therefore, it needs the usage data (last values) for storing the required information.

Using this report for a checkpoint would always use the latest execution (usage data/last values) to find the required information needed to run the report from scratch.

Example

The following parameter was applied when preparing the checkpoint within the Lasernet Archive for the report Cust account statement:

Customer account statement

The screenshot shows the 'Parameters' section for the 'Customer account statement' report. It includes several configuration options:

- Use print management destination:** A toggle switch set to 'No'.
- Show credit limit:** A toggle switch set to 'No'.
- CRITERIA:**
 - Date interval:** A dropdown menu.
 - From date:** A date input field containing '8/1/2000', highlighted with a red box.
 - To date:** A date input field containing '8/30/2023'.
 - Only open:** A toggle switch set to 'No'.
- Show due until:** An empty date input field.
- MATURITY DISTRIBUTION:**
 - Show maturity distribution:** A toggle switch set to 'No'.
 - AGING PERIOD DEFINITIONS:** A radio button is selected.
 - Aging period definition:** A text input field.
 - Print period description:** A text input field.

When running the Test for this checkpoint, the system lets the user know the test is passed:

Finance and Operations Preview Lasernet > Common > Archive

← Edit Delete Options

Filter

Start date/time	Checkpoint
8/30/2023 3:45:29 AM	CustAccountStater

Standard view

Test results

CustAccountStatement_Replacement_008 (CustAccountStatement_Re)

Test execution

User ID	Test flow
Kim.A	

Log

Testing checkpoint: 'CustAccountStatement_Replacement_008'

[i] Test passed.

The test will show as failing if either the parameters are changed or another user is running the same checkpoint and they have other parameters set for the report (usage data/last values).

Customer account statement

Parameters

Default 🔍 Lasernet Screen

Use print management destination No

Show credit limit No

CRITERIA

Date interval

From date

To date

Show due until

MATURITY DISTRIBUTION

Show maturity distribution No

AGING PERIOD DEFINITIONS

Aging period definition

Standard view ▼

Test results

CustAccountStatement_Replacement_008 (CustAccountStatement_Replacement): Fail

Test execution			
User ID	Test flow	Checkpoint	Report name
KimA		CustAccountStatement_Replac...	CustAccountStatement_Replac...

Log

```

Testing checkpoint: 'CustAccountStatement_Replacement_008'
Report: CustAccountStatement_Replacement
[Error] Element 'Report/Page-Header/FIELD_FromData' is not in not equal in checkpoint and result: '8/1/2000' - '8/1/2023'
[Error] Element 'Report/CustTable/Detail_Collection/Detail/CustAccountStatementExtTmp/Detail_Collection/Detail/FIELD_CustAccountStatementExtTmp_CustTrans_Bal'
[Error] Element 'Report/CustTable/Detail_Collection/Detail/CustAccountStatementExtTmp/Detail_Collection/Detail/FIELD_CustAccountStatementExtTmp_CustTrans_Cur'
[Error] Element 'Report/CustTable/Detail_Collection/Detail/CustAccountStatementExtTmp/Detail_Collection/Detail/FIELD_CustAccountStatementExtTmp_CustTrans_Det'
[Error] Test failed.

```

Note

The usage data (last values) are saved per user. This can also cause different results when making a comparison.

Throw error

Throw error provides the option to simulate an exception/error. This is quite useful in relation to negative testing.

Location: **Lasernet** > **Test and performance suite** > **Test** > **Tools** > **Throw error**

Expand all Collapse all

- Common
 - Tools
 - Throw error
 - Mobile
 - Performance
 - Batch print schedule (Batch bundling)
 - Batch print schedule (Top picking)
 - Batch print review
- Reports
- Archive
- Backup
 - Export Lasernet backup
 - Import Lasernet backup
 - Copy Lasernet reports & configuration to other companies

368759@LAC365FO - SameLevel was producing just 1 and 1 record instead of fetching all.

Layout generation had to be reviewed

For each table within the Query Wizard, it is possible to specify how data should be collected/fetched and added to the output (XML file).

Data is either "Nested" or added at same level as the parent data source (table).

In previous versions, using SameLevel only added one record from the parent data source/table and one record from the child data source/table.

In the following example the parent data source SalesTable was only added once.

Selected tables

Relation/Layout Load from report... Copy/Link query Up Down Copy/Move Labels

Filter

Data sources

Query

SalesTable

Layout	Symbol
Nested	Nested
SameLevel	Same level as parent

PROPERTIES

Property	
Parent	
Join	
Fetch	
Layout	Nested
Top records	
Top reset	Report
Create element	Yes

Layout of data source in XML document

In Lasernet FO Connector 6.19, parent data source is added once and child data sources are added as many times as records exist for the child data source.

Previous version of Lascript FO Connector	Lascript FO Connector 6.19
<pre> <-Labels> <LABEL_Record_ID>Record ID</ LABEL_Record_ID> <LABEL_Sales_order>Sales order</ LABEL_Sales_order> <LABEL_Record_ID1>Record ID</ LABEL_Record_ID1> <LABEL_Sales_order1>Sales order</ LABEL_Sales_order1> <LABEL_Item_number>Item number</ LABEL_Item_number> </ Labels> <-SalesTable> <-SalesTable_Detail> <LACQueryRecord_DONOT_CHANGE_SalesTable>1</ LACQueryRecord_DONOT_CHANGE_SalesTable> <FIELD_SalesTable_RecId>5637144576</ FIELD_SalesTable_RecId> <FIELD_SalesTable_SalesId>000002</ FIELD_SalesTable_SalesId> </ SalesTable_Detail> <-SalesLine_Detail> <LACQueryRecord_DONOT_CHANGE_SalesLine>6</ LACQueryRecord_DONOT_CHANGE_SalesLine> <FIELD_SalesLine_RecId>5637144580</ FIELD_SalesLine_RecId> <FIELD_SalesLine_SalesId>000002</ FIELD_SalesLine_SalesId> <FIELD_SalesLine_ItemId>D0004</ FIELD_SalesLine_ItemId> </ SalesLine_Detail> </ SalesTable> </pre>	<pre> <-Labels> <LABEL_Record_ID>Record ID</ LABEL_Record_ID> <LABEL_Sales_order>Sales order</ LABEL_Sales_order> <LABEL_Record_ID1>Record ID</ LABEL_Record_ID1> <LABEL_Sales_order1>Sales order</ LABEL_Sales_order1> <LABEL_Item_number>Item number</ LABEL_Item_number> </ Labels> <-SalesTable> <-SalesTable_Detail> <LACQueryRecord_DONOT_CHANGE_SalesTable>1</ LACQueryRecord_DONOT_CHANGE_SalesTable> <FIELD_SalesTable_RecId>5637144576</ FIELD_SalesTable_RecId> <FIELD_SalesTable_SalesId>000002</ FIELD_SalesTable_SalesId> </ SalesTable_Detail> <-SalesLine_Detail> <LACQueryRecord_DONOT_CHANGE_SalesLine>2</ LACQueryRecord_DONOT_CHANGE_SalesLine> <FIELD_SalesLine_RecId>5637144576</ FIELD_SalesLine_RecId> <FIELD_SalesLine_SalesId>000002</ FIELD_SalesLine_SalesId> <FIELD_SalesLine_ItemId>D0001</ FIELD_SalesLine_ItemId> </ SalesLine_Detail> <-SalesLine_Detail> <LACQueryRecord_DONOT_CHANGE_SalesLine>3</ LACQueryRecord_DONOT_CHANGE_SalesLine> <FIELD_SalesLine_RecId>5637144577</ FIELD_SalesLine_RecId> <FIELD_SalesLine_SalesId>000002</ FIELD_SalesLine_SalesId> <FIELD_SalesLine_ItemId>L0001</ FIELD_SalesLine_ItemId> </ SalesLine_Detail> <-SalesLine_Detail> <LACQueryRecord_DONOT_CHANGE_SalesLine>4</ LACQueryRecord_DONOT_CHANGE_SalesLine> <FIELD_SalesLine_RecId>5637144578</ FIELD_SalesLine_RecId> <FIELD_SalesLine_SalesId>000002</ FIELD_SalesLine_SalesId> <FIELD_SalesLine_ItemId>P0001</ FIELD_SalesLine_ItemId> </ SalesLine_Detail> <-SalesLine_Detail> <LACQueryRecord_DONOT_CHANGE_SalesLine>5</ LACQueryRecord_DONOT_CHANGE_SalesLine> <FIELD_SalesLine_RecId>5637144579</ FIELD_SalesLine_RecId> <FIELD_SalesLine_SalesId>000002</ FIELD_SalesLine_SalesId> <FIELD_SalesLine_ItemId>D0003</ FIELD_SalesLine_ItemId> </ SalesLine_Detail> </pre>

Remember to enable Fetch/ Fetchmode if records for the child data source need to get sorted at same level as the parent data source.

In some situations, this requires the use of the Fetch/ Fetch mode 1:1 for the Query within the Query Wizard.

It is not always enough having the records at **Same Level as parent** as the Layout is only the representation (XML file) and not the way the records should be fetched through the Query.

Choose default sort order. You will be able to change sort order in report dialog.

Available fields

Filter

SalesLine

SalesLine

ActivityNumber

AddressRefRecid

AddressRefTableId

AgreementSkipAutoLink

Sort by

↑ Up ↓ Down

Filter

SalesTable

SalesLine

Itemid

Ascending (A-Z)

Descending (Z-A)



Related Content

- [Lasernet FO Connector 6.19](#)
- [Lasernet FO Connector 6.19 is now available](#)
- [Lasernet FO Connector 6.19 Release Notes](#)
- [Lasernet FO Connector 6.19 New Features \(part II\)](#)
- [Lasernet FO Connector 6.19 New Features \(part I\)](#)
- [Lasernet FO Connector 6.19 New Features \(part III\)](#)
- [Lasernet FO Connector 6.19 New Features \(part IV\)](#)
- [Lasernet FO Connector 6.19 New Features \(part V\)](#)
- [Lasernet FO Connector 6.19 New Features \(part VI\)](#)